

INSTRUCTION SHEET

EXTERNAL SOLENOID SUPPLY (K SERIES)

RELEASED: 1-12-01
REVISED:
PART #: 119999-71
(REV. A)

GENERAL INFORMATION

To change the K Series Valves from an internal to an external source of pilot air.

INSTALLATION

CAUTION: ISOLATE THE VALVE TO BE CONVERTED FROM ALL SOURCES OF AIR PRESSURE. Failure to do this could expose the operator to unregulated sources of high pressure air and cause personal injury.

SEE FIGURE 2

1. Remove the screws that are holding the end cap.
 2. Remove the gasket and rotate 90°.
- NOTE: Make sure the hole in the gasket does NOT line up with the internal solenoid supply hole in the body. See figure 1.
3. Re-assemble the end cap to body using the screws. Torque the screws to 85 - 130 inch lbs. (9.6 - 14.7 Nm).
 4. Remove the pipe plug from the end cap.
 5. Connect the external pilot air supply to the valve using a 1/8 NPT male connector. The connector should be installed to a torque value of 40 - 50 inch lbs. (4.5 - 5.6 Nm). DO NOT OVER-TIGHTEN. The application of excessive torque to the connector can damage the end cap and cause leakage.
 6. If the valve is a double solenoid, repeat for the other end of valve.

INTERNAL SOLENOID SUPPLY

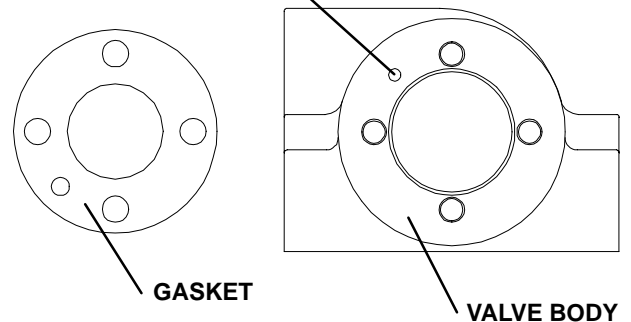

FIGURE 1

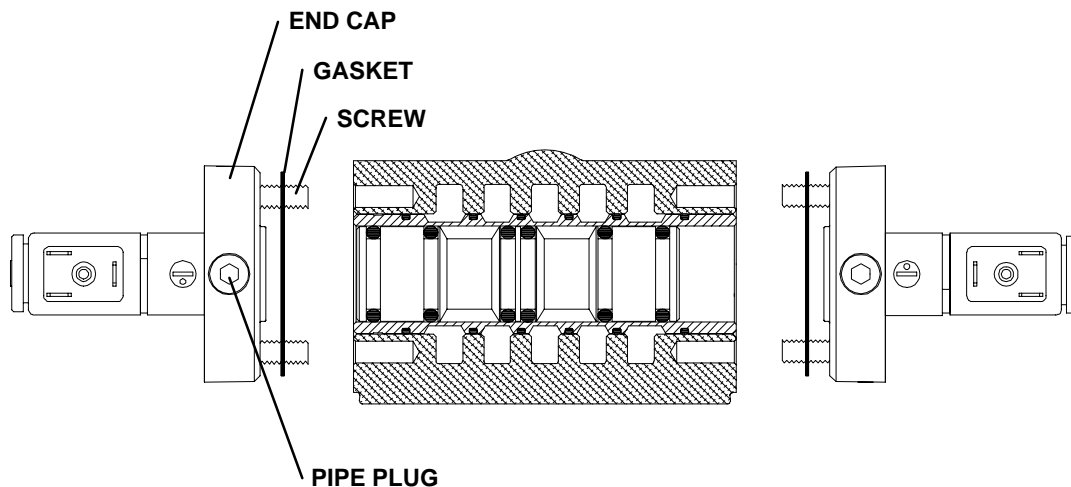

FIGURE 2